



**10GHZ N MALE TO REVERSE SMA MALE**

**ADAPTER**

**P/NO.STI01-STI01-0111**



**SPECIFICATION**

Frequency	DC-10GHz
VSWR:	1.2:1(Max.)
Impedance:	50Ohm
Durability:	500 Cycles
Temperature:	-65~155℃

**MATERIAL LIST**

Part	Material	Plated
Body	Brass	Nickel
Center Contact	Phosphor Bronze	Gold
Insulator	Teflon	
C-Ring	Stainless Steel	
Gasket	Silicon	
Center Contact	Phosphor Bronze	Gold
Insulator	Teflon	
C-Ring	Beryllium Copper	Gold
Body	Brass	Nickel
Shell	Brass	Nickel

**OUTLINE DRAWING**

Unit:mm

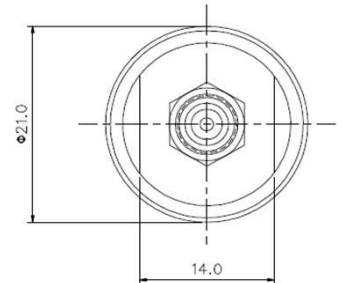
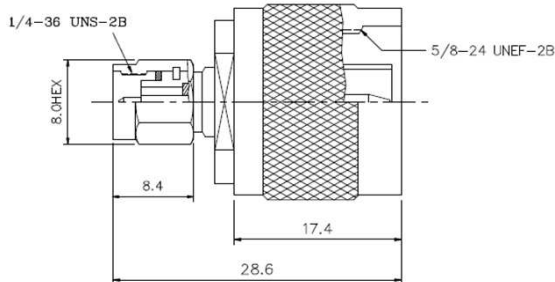

**TESTING DATA ( 100% S-PARAMETER TESTED)**

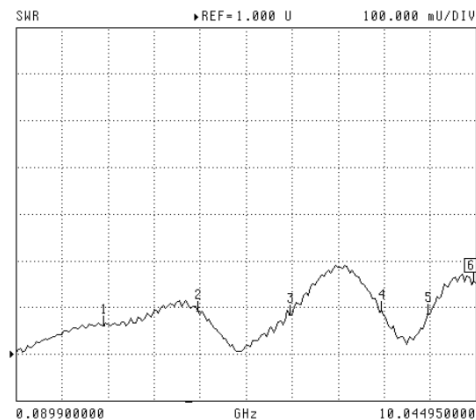

Any more request, please contact sales@solvangtech.com. Thank you ~