

10GHZ N FEMALE TO SMA MALE

ADAPTER

P/NO.STI01-0113



SPECIFICATION

Frequency	DC-10GHz
VSWR:	1.25:1(Max.)
Impedance:	50Ohm
Durability:	500 Cycles
Temperature:	-65~155℃

MATERIAL LIST

Part	Material	Plated
Body	Brass	Copper-Tin-Zinc
Center Contact	Phosphor Bronze	Gold
Insulator	Teflon	
C-Ring	BerylliumCopper	
Gasket	Silicon	
Shell	Brass	Copper-Tin-Zinc

OUTLINE DRAWING

Unit:mm

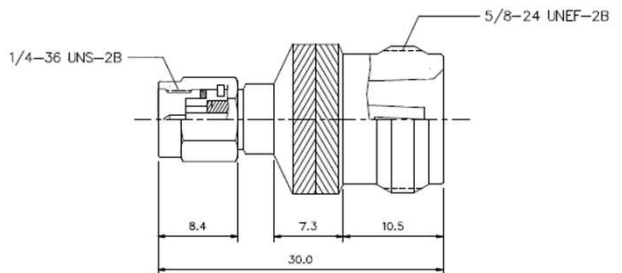
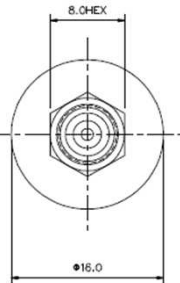

TESTING DATA (100% S-PARAMETER TESTED)

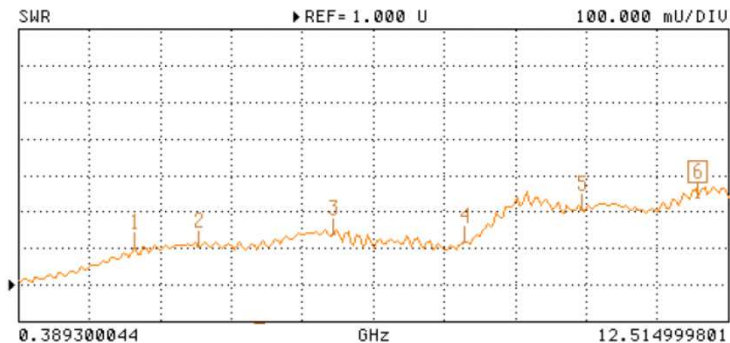

Any more request, please contact sales@solvangtech.com. Thank you ~