



10GHZ N MALE TO REVERSE SMA FEMALE

ADAPTER

P/NO.STI01-0116



SPECIFICATION

Frequency	DC-10GHz
VSWR:	1.2:1(Max.)
Impedance:	50ohm
Durability:	500 Cycles
Temperature:	-65~155 °C

MATERIAL LIST

Part	Material	Plated
Body	Brass	Nickel
Center Contact	Brass	Gold
Insulator	Teflon	
C-Ring	Stainless Steel	
Gasket	Silicon	
Shell	Brass	Nickel

OUTLINE DRAWING

Unit:mm

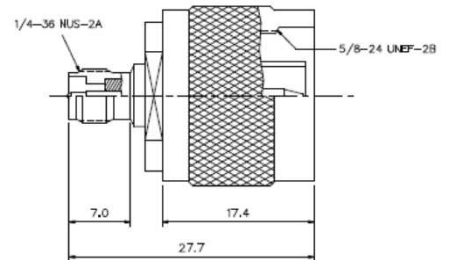
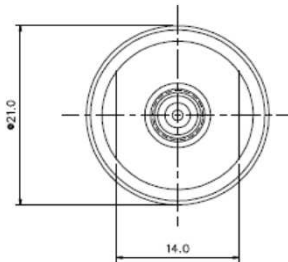

TESTING DATA (100% S-PARAMETER TESTED)

